

FICHA CATASTRAL

Código Catastral Fiscal 05 60 001 37 01 01 01 001
 Código Catastral Ant. SUB LOTE IB - AV. COL.-TE
 Código Predial

Código Estructura
 Ex Sec - Mza - Lt - -
 Zonificación

DATOS DEL PROPIETARIO

Doc Identidad	Apellidos Nombres / Razón Social	F. Adquisición	Código	Teléfono	Part %
01 - 205258586-OL & AS CONTRATISTA GENERALES SCRL.			10003238		0.000

Via:10028 Dirección: PIURA-PIURA-PIURA -

Urbanización : 008 - Santa Isabel
 Exoneración : - Motivo : - Base Legal :
 Expediente : Nro Resolución : Fecha de Resolución :
 Fecha de Venc. Res. :

Tipo de Propietario : 11 - Empresa Condición Propiedad : 3 - Poseedor o Tenedor

CARACTERISTICAS DE LA UNIDAD CATASTRAL

Código de Usos	: 090101 - CASA HABITACION	Agua	: N -	Kardex	:
Situación Pr.	: 1 - Terreno sin/construir	Desague	: N -	Tomo / Fi.	:
Tipo Edificac.	: 5 - Terreno	Electr.	: N -	Folio	:
Estado Adqu.	: Terminado	Telefono	: N	Asiento	:

Area de Terreno	Declarada	Gráfica	Encuesta Propia	Encuesta Total		
	102,755.77	102,755.77	0.00	0.00		
Area Común	Area Terreno	Area	%B. Común	%B. Común	%B. Común	
Total del Lote	102,755.77	0.00	0.00	0.00	0.00	0.00

Linderos del Lote: Area: Frente: Derecha: Izquierda: Fondo:

Observaciones :

INGRESADO CON EXP. N° 10145 (04/09/2023)
 ATENDIDO CON INFORME N° 89-2023-MDLH-AJAZ
 CON PARTIDA REGISTRAL N° 11246290
 INSPECTOR:
 - ANGEL ANTON ZETA
 - FRANKLIN SOJO FREYRE
 REGISTRADOR:
 - FRANKLIN SOJO FREYRE

Tipo de Licencia	Nro de Licencia	Nro Expediente	Fec. Tramite	Fec. Caducidad	Area	Niveles

Inspector :

Fec. Insp. :



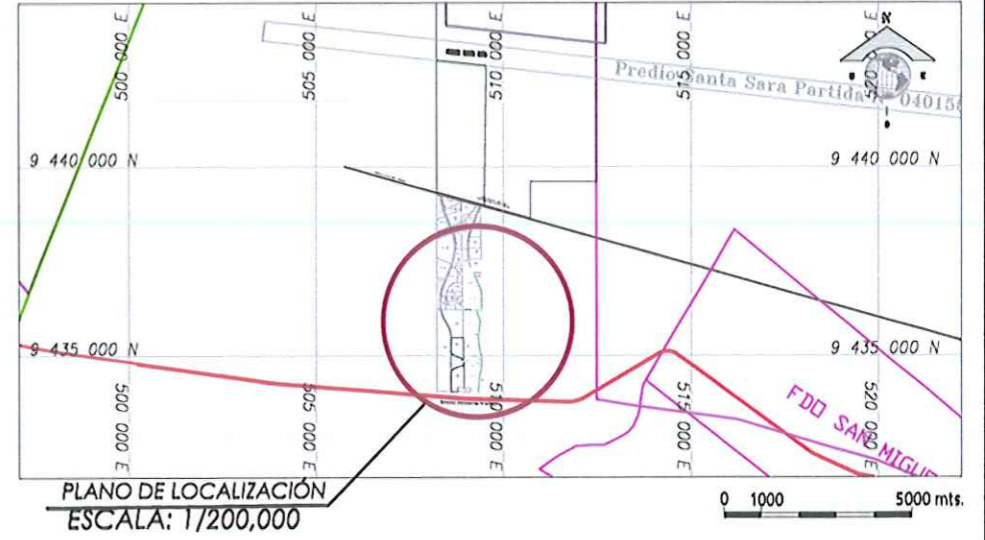

CUADRO DE COORDENADAS DE SUBLOTE IB - TAHITI - AV. COLECTORA TB

AREA = 102 755.77 m² / 10 275.8 H^a
PERIMETRO = 7 528.08 m

VERTICE	LADO	DISTANCIA	ANG. INTERNO	ESTE (X)	NORTE (Y)
1	1-2	108.20	200°24'5"	509550.4118	9438531.5251
2	2-3	228.18	173°48'1"	509583.8188	9438430.2830
3	3-4	40.84	167°11'38"	509829.5840	9438218.2045
4	4-5	842.21	180°57'50"	509821.9889	9438178.2749
5	5-6	162.63	162°45'33"	509824.4257	9435538.2132
6	6-7	160.58	173°59'8"	509860.9485	9435379.7399
7	7-8	178.35	168°10'32"	509882.7893	9435200.8521
8	8-9	168.80	173°53'0"	509881.8858	9435027.0883
9	9-10	320.67	187°8'42"	509824.4272	9434884.5319
10	10-11	145.44	185°51'58"	509591.7055	9434548.0548
11	11-12	24.81	88°7'19"	509591.7055	9434400.8174
12	12-13	144.87	91°52'41"	509588.9055	9434401.4308
13	13-14	325.92	174°7'45"	509588.9055	9434548.1052
14	14-15	167.08	172°53'35"	509800.1890	9434889.7805
15	15-16	169.79	188°8'18"	509837.7119	9435032.8085
16	16-17	174.90	183°51'0"	509857.9835	9435200.8708
17	17-18	162.88	188°0'4"	509838.7889	9435374.1401
18	18-19	852.22	167°14'51"	509800.1876	9435532.9544
19	19-20	41.11	169°11'48"	509597.8344	9438180.9855
20	20-21	205.72	202°51'18"	509805.2997	9438221.3598
21	21-22	123.39	188°4'20"	509593.5447	9438418.9888
22	22-23	50.08	159°41'28"	509525.6074	9438531.4778
23	23-24	381.72	272°7'37"	509527.4681	9438581.5258
24	24-25	24.80	90°52'25"	509165.7492	9438581.5258
25	25-26	492.88	89°7'35"	509165.3711	9438808.3258
26	26-27	437.85	271°7'1"	509848.2294	9438808.3258
27	27-28	40.82	168°50'31"	509839.8943	9437044.0928
28	28-29	81.90	190°58'12"	509834.0833	9437084.2258
29	29-30	98.87	184°22'38"	509807.5340	9437181.8420
30	30-31	340.00	179°11'49"	509589.2087	9437250.8092
31	31-32	38.88	88°19'34"	509439.0842	9437584.7163
32	32-33	.78	160°17'17"	509472.9889	9437677.8153
33	33-34	338.25	111°23'14"	509473.7701	9437677.8308
34	34-35	98.88	180°48'8"	509803.2351	9437285.1411
35	35-36	92.08	178°22'29"	509841.5559	9437176.1889
36	36-37	507.60	162°28'10"	509871.0243	9437089.0307
37	37-38	128.84	88°52'59"	509880.8191	9438581.5258
38	38-1	50.04	287°51'58"	509552.2769	9438581.5258
TOTAL		7528.08	6478°59'87"		

AREA = 102 755.77 m² / 10 275.8 H^a
PERIMETRO = 7 528.08 m

VERTICE	LADO	DISTANCIA	ANG. INTERNO	ESTE (X)	NORTE (Y)
1	1-2	108.20	200°24'5"	509550.4118	9438531.5251
2	2-3	228.18	173°48'1"	509583.8188	9438430.2830
3	3-4	40.84	167°11'38"	509829.5840	9438218.2045
4	4-5	842.21	180°57'50"	509821.9889	9438178.2749
5	5-6	162.63	162°45'33"	509824.4257	9435538.2132
6	6-7	160.58	173°59'8"	509860.9485	9435379.7399
7	7-8	178.35	168°10'32"	509882.7893	9435200.8521
8	8-9	168.80	173°53'0"	509881.8858	9435027.0883
9	9-10	320.67	187°8'42"	509824.4272	9434884.5319
10	10-11	145.44	185°51'58"	509591.7055	9434548.0548
11	11-12	24.81	88°7'19"	509591.7055	9434400.8174
12	12-13	144.87	91°52'41"	509588.9055	9434401.4308
13	13-14	325.92	174°7'45"	509588.9055	9434548.1052
14	14-15	167.08	172°53'35"	509800.1890	9434889.7805
15	15-16	169.79	188°8'18"	509837.7119	9435032.8085
16	16-17	174.90	183°51'0"	509857.9835	9435200.8708
17	17-18	162.88	188°0'4"	509838.7889	9435374.1401
18	18-19	852.22	167°14'51"	509800.1876	9435532.9544
19	19-20	41.11	169°11'48"	509597.8344	9438180.9855
20	20-21	205.72	202°51'18"	509805.2997	9438221.3598
21	21-22	123.39	188°4'20"	509593.5447	9438418.9888
22	22-23	50.08	159°41'28"	509525.6074	9438531.4778
23	23-24	381.72	272°7'37"	509527.4681	9438581.5258
24	24-25	24.80	90°52'25"	509165.7492	9438581.5258
25	25-26	492.88	89°7'35"	509165.3711	9438808.3258
26	26-27	437.85	271°7'1"	509848.2294	9438808.3258
27	27-28	40.82	168°50'31"	509839.8943	9437044.0928
28	28-29	81.90	190°58'12"	509834.0833	9437084.2258
29	29-30	98.87	184°22'38"	509807.5340	9437181.8420
30	30-31	340.00	179°11'49"	509589.2087	9437250.8092
31	31-32	38.88	88°19'34"	509439.0842	9437584.7163
32	32-33	.78	160°17'17"	509472.9889	9437677.8153
33	33-34	338.25	111°23'14"	509473.7701	9437677.8308
34	34-35	98.88	180°48'8"	509803.2351	9437285.1411
35	35-36	92.08	178°22'29"	509841.5559	9437176.1889
36	36-37	507.60	162°28'10"	509871.0243	9437089.0307
37	37-38	128.84	88°52'59"	509880.8191	9438581.5258
38	38-1	50.04	287°51'58"	509552.2769	9438581.5258
TOTAL		7528.08	6478°59'87"		

ING. ELMER LUIGI TUME ESPINOZA
SUB GERENTE DE OBRAS PRIVADAS Y RURAL
MUNICIPALIDAD DE LA HUACA - PAITA





Municipalidad de
LA HUACA
avanzamos contigo
Gestión 2023 - 2026



**MUNICIPALIDAD DISTRITAL
DE LA HUACA**
DEPARTAMENTO DE OBRAS PRIVADAS Y CATASTRO

PROFESIONAL RESPONSABLE: **ING. ELMER LUIGI TUME ESPINOZA**

PLANO: PLANO CATASTRAL	LAMINA: PC-01
SUBLOTE IA - TAHITI - AV. COLECTORA TB	
ESCALA: INDICADA	FECHA: SETIEMBRE 2023

PLANO UBICACIÓN
ESCALA: 1/25,000
0 100 500 1000mts.

Carretera Interoceánica Palta-Palta

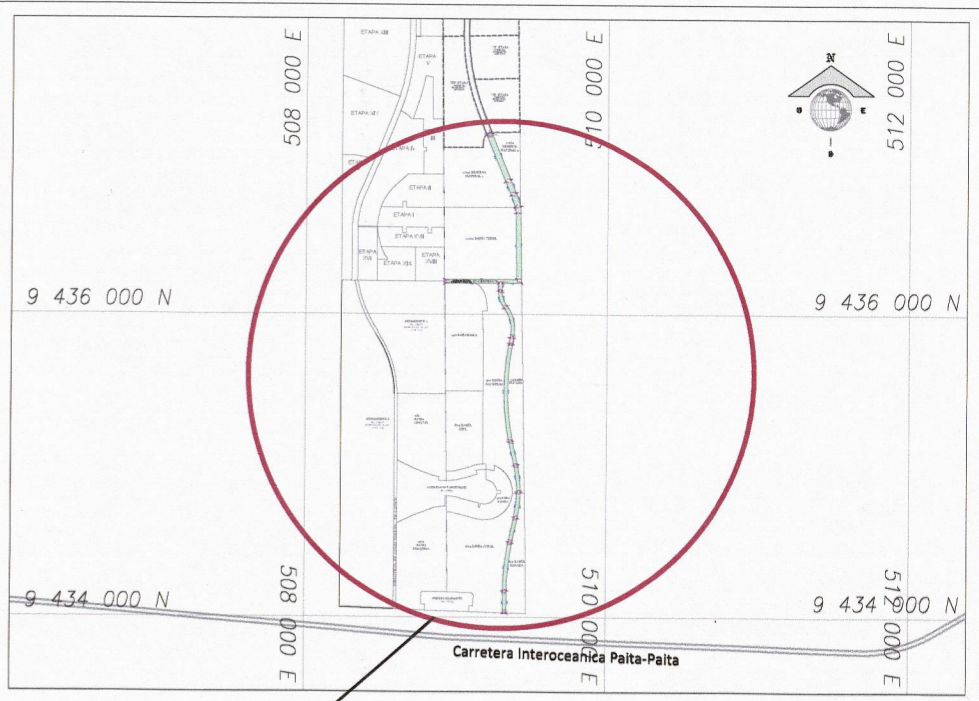
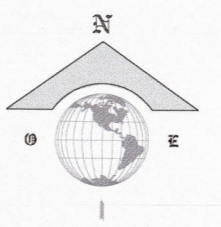
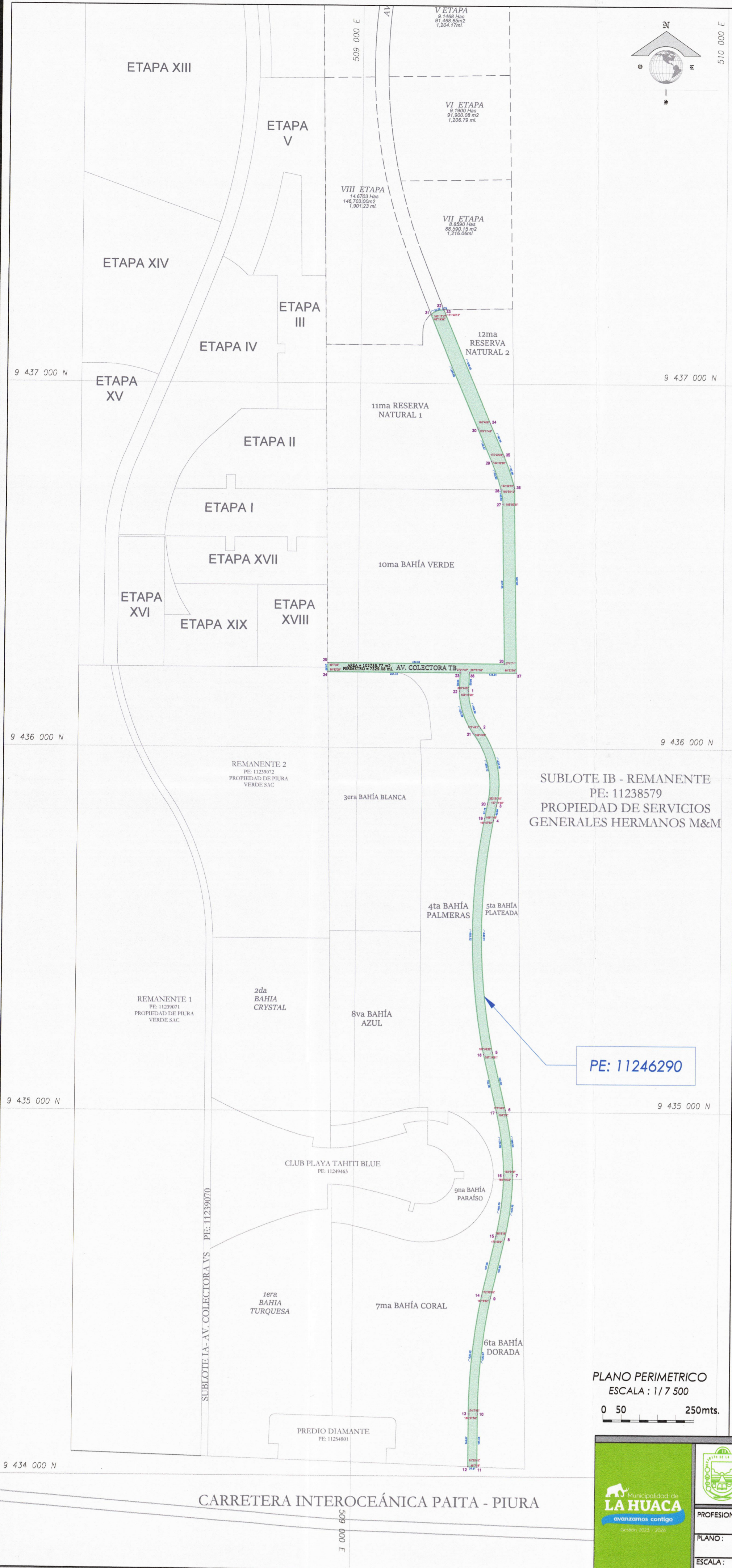

PLANO DE LOCALIZACIÓN
ESCALA: 1/1100,000

CUADROS DE COORDENADAS

AREA = 102,755.77 m² / 10,2756 Ha
PERIMETRO = 7,528.08 ml.

SISTEMA DATUM WGS 84 - ZONA 17 SUR

VERTICE	LADO	DISTANCIA	ANG. INTERNO	ESTE (X)	NORTE (Y)
1	1-2	108.20	200°24'5"	509550.4116	9436531.5251
2	2-3	226.16	173°48'1"	509583.8188	9436430.2830
3	3-4	40.84	157°11'36"	509629.5640	9436216.2045
4	4-5	642.21	190°57'50"	509621.9869	9436176.2749
5	5-6	162.63	192°45'33"	509624.4257	9435538.2132
6	6-7	180.56	173°59'6"	509660.9485	9435379.7399
7	7-8	175.35	166°10'32"	509682.7963	9435200.8521
8	8-9	166.80	173°53'0"	509661.8856	9435027.0683
9	9-10	320.67	187°6'42"	509624.4272	9434864.5319
10	10-11	145.44	185°51'58"	509591.7055	9434546.0548
11	11-12	24.81	88°7'19"	509591.7055	9434400.6174
12	12-13	144.67	91°52'41"	509566.9055	9434401.4308
13	13-14	325.92	174°7'45"	509566.9055	9434546.1052
14	14-15	167.08	172°53'35"	509600.1890	9434869.7905
15	15-16	169.79	186°6'18"	509637.7119	9435032.6065
16	16-17	174.90	193°51'0"	509657.9935	9435200.8706
17	17-18	162.98	186°0'4"	509636.7889	9435374.1401
18	18-19	652.22	167°14'51"	509600.1875	9435532.9644
19	19-20	41.11	169°1'46"	509597.8344	9436180.9655
20	20-21	205.72	202°51'16"	509605.2897	9436221.3598
21	21-22	123.39	186°4'20"	509563.5447	9436415.9888
22	22-23	50.08	159°41'28"	509525.6074	9436531.4779
23	23-24	361.72	272°7'37"	509527.4661	9436581.5256
24	24-25	24.80	90°52'25"	509165.7492	9436581.5256
25	25-26	482.88	89°7'35"	509165.3711	9436606.3256
26	26-27	437.85	271°7'1"	509648.2294	9436606.3256
27	27-28	40.62	186°50'31"	509639.6943	9437044.0926
28	28-29	81.90	190°58'12"	509634.0833	9437084.2256
29	29-30	96.87	184°22'36"	509607.5340	9437161.6420
30	30-31	340.00	179°11'49"	509569.2087	9437250.6082
31	31-32	36.88	88°19'34"	509439.0842	9437564.7163
32	32-33	.78	160°17'17"	509472.9898	9437577.6153
33	33-34	338.25	111°23'14"	509473.7701	9437577.6308
34	34-35	96.86	180°48'6"	509603.2351	9437265.1411
35	35-36	92.08	175°22'29"	509641.5559	9437178.1869
36	36-37	507.60	162°26'10"	509671.0243	9437089.0307
37	37-38	128.64	88°52'59"	509680.9191	9436581.5256
38	38-1	50.04	267°51'36"	509652.2799	9436581.5256
TOTAL		7528.08	6479°59'57"		

AREA = 102,755.77 m² / 10,2756 Ha
PERIMETRO = 7,528.08 ml.

SISTEMA DATUM PSAD 56 - ZONA 17 SUR

VERTICE	LADO	DISTANCIA	ANG. INTERNO	ESTE (X)	NORTE (Y)
1	1-2	108.20	200°24'5"	509550.4116	9436531.5251
2	2-3	226.16	173°48'1"	509583.8188	9436430.2830
3	3-4	40.84	157°11'36"	509629.5640	9436216.2045
4	4-5	642.21	190°57'50"	509621.9869	9436176.2749
5	5-6	162.63	192°45'33"	509624.4257	9435538.2132
6	6-7	180.56	173°59'6"	509660.9485	9435379.7399
7	7-8	175.35	166°10'32"	509682.7963	9435200.8521
8	8-9	166.80	173°53'0"	509661.8856	9435027.0683
9	9-10	320.67	187°6'42"	509624.4272	9434864.5319
10	10-11	145.44	185°51'58"	509591.7055	9434546.0548
11	11-12	24.81	88°7'19"	509591.7055	9434400.6174
12	12-13	144.67	91°52'41"	509566.9055	9434401.4308
13	13-14	325.92	174°7'45"	509566.9055	9434546.1052
14	14-15	167.08	172°53'35"	509600.1890	9434869.7905
15	15-16	169.79	186°6'18"	509637.7119	9435032.6065
16	16-17	174.90	193°51'0"	509657.9935	9435200.8706
17	17-18	162.98	186°0'4"	509636.7889	9435374.1401
18	18-19	652.22	167°14'51"	509600.1875	9435532.9644
19	19-20	41.11	169°1'46"	509597.8344	9436180.9655
20	20-21	205.72	202°51'16"	509605.2897	9436221.3598
21	21-22	123.39	186°4'20"	509563.5447	9436415.9888
22	22-23	50.08	159°41'28"	509525.6074	9436531.4779
23	23-24	361.72	272°7'37"	509527.4661	9436581.5256
24	24-25	24.80	90°52'25"	509165.7492	9436581.5256
25	25-26	482.88	89°7'35"	509165.3711	9436606.3256
26	26-27	437.85	271°7'1"	509648.2294	9436606.3256
27	27-28	40.62	186°50'31"	509639.6943	9437044.0926
28	28-29	81.90	190°58'12"	509634.0833	9437084.2256
29	29-30	96.87	184°22'36"	509607.5340	9437161.6420
30	30-31	340.00	179°11'49"	509569.2087	9437250.6082
31	31-32	36.88	88°19'34"	509439.0842	9437564.7163
32	32-33	.78	160°17'17"	509472.9898	9437577.6153
33	33-34	338.25	111°23'14"	509473.7701	9437577.6308
34	34-35	96.86	180°48'6"	509603.2351	9437265.1411
35	35-36	92.08	175°22'29"	509641.5559	9437178.1869
36	36-37	507.60	162°26'10"	509671.0243	9437089.0307
37	37-38	128.64	88°52'59"	509680.9191	9436581.5256
38	38-1	50.04	267°51'36"	509652.2799	9436581.5256
TOTAL		7528.08	6479°59'57"		

PE: 11246290

PLANO PERIMETRICO
ESCALA: 1/7 500



ING. ELMER LUIGI TUME ESPINOZA
SUB GERENTE DE OBRAS DE DESARROLLO URBANO Y RURAL
MUNICIPALIDAD DISTRITAL DE LA HUACA - PAITA

MUNICIPALIDAD DISTRITAL DE LA HUACA
DEPARTAMENTO DE OBRAS PRIVADAS Y CATASTRO

PROFESIONAL RESPONSABLE: ING. ELMER LUIGI TUME ESPINOZA

PLANO: PLANO CATASTRAL SUBLOTE IA - TAHITI - AV. COLECTORA TB

ESCALA: INDICADA FECHA: SETIEMBRE 2023

LAMINA: **PC-02**

CARRETERA INTEROCEÁNICA PAITA - PIURA